

# PCI-2SD2-RS-R40

## 2-Slot Backplane with 2 PCI Bus User Manual Ver. 4.0

### 1. PW2: ATX Power Connector

Pin	Description	Pin	Description
1	+3.3Vdc	11	+3.3Vdc
2	+3.3Vdc	12	-12Vdc
3	GND	13	GND
4	+5Vdc	14	PS-ON
5	GND	15	GND
6	+5Vdc	16	GND
7	GND	17	GND
8	PWR-OK	18	-5Vdc
9	+5VSB	19	+5Vdc
10	+12Vdc	20	+5Vdc

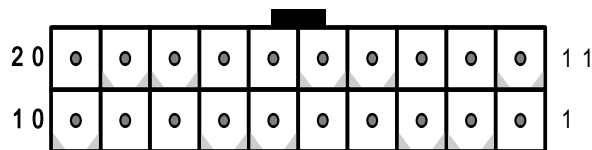

### 2. PW1: POWER CONNECTOR

PIN	DESCRIPTION
1	+5V
2	GND
3	GND
4	+12V
5	-5V
6	GND
7	+5V
8	-12V

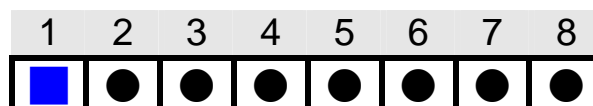

### 3. ATXCTL1: Backplane to Mainboard ATX power control Connector

Pin	Description
1	GND
2	PSON#
3	5VSB

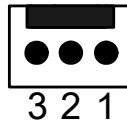

### 4. PCI routing table:

PCI ROUTING		
SIGNAL	PCI 1	PCI 2
REQ#	REQ0#	REQ1#
GNT#	GNT0#	GNT1#
CLOCK	CLK0	CLK1
IDSEL	AD19	AD20
INTA#	A	D
INTB#	B	A
INTC#	C	B
INTD#	D	C

### 5. Notice:

Recommend to use 6mm width spacer to install

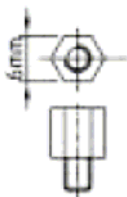

b. Torsion must less than 6lb-inch

## 6. Dimension:

